



PROJECT		REF		REV	ITEM CODE	
LOCATION		DATE			PAGE	

## SANITARY WARE SPECIFICATION SHEET

Item Descriptions	FASTDRY (Taiwan) "ECOMO" ABS high speed square-Shaped Jet Hand Dryer with <b>back absorbent ceramic pad</b> absorbing water in white colour ; <b>LED color</b> in operation ; drying time less than 10-15 seconds ; adjustable air speed 75-90m/s ; built-in heater element switch On/Off ; 220-240 Vac, 50/60 Hz, 6.1-607A, 1.34-1.6kW
Dimensions	L322 x W185 x H588mm
Model	ECOMO11 (Disabled)
Material	ABS
Manufacturer	FASTDRY (Taiwan)
Supplier	Acme Sanitary Ware Co. Ltd Mr. Eric Wong/ Mr. Don Yuen
Contact Tel/Fax	(852) 2388-7171 / (852) 2710-8012
E-mail	acme@acmesanitary.com.hk
Website	www.acmesanitary.com.hk

Illustration/ Drawing





The absorbent ceramic pad







**Safety Approvals**

**TECHNICAL SPECIFICATIONS**

Operating Voltage	110-120 Vac, 50/60 Hz, 12.2-13.4 A, 1.34-1.6 kW 220-240 Vac, 50/60 Hz, 6.1-6.7 A, 1.34-1.6 kW
Warm Air Speed Output	75-95 m/s (169-212.5 mi/hr) , adjustable
Air Output Temperature	55 °C (131 °F) with an Ambient Temp. of 25 °C (77 °F)
Dryer Shall Deliver	137 m³/h (80 CFM)
Cover Type	3.0 mm thick molded Antibacterial ABS plastic
Motor Type	350-700 W, 12,000-18,000 R.P.M., adjustable, brush motor
Motor Thermal Protection	Auto Resetting Thermostat turns unit off, 120V at 135 °C (275 °F), 240V/277V at 95 °C (203 °F)
Heater Element	ON/ OFF switch available. Power 450-900W depending on air speed
Heater Thermal Protection	Auto Resetting Thermostat turns unit off at 85 °C (185 °F) Thermal cut-off at 142 °C (288 °F)
Standby Power	0.3-0.4 W
LED Color	Standby: Red; Active: Blue
Drying Time	Less than 10-15 seconds
Circuit Operation	Infrared Automatic, self adjusting
Sensor Range	standard 150 mm ± 20 mm (5.9"), adjustable
Sound Pressure	MIN 69.6 dB to 72.8 dB MAX @ 1m
Timing Protection	60 seconds auto shut off
Drip proof	IP21 or IP24 (Optional)
Isolation	Class 1
Net Weight	9.4 kg (20.7 lbs)
Shipping Weight	11.4 kg (25.1 lbs)
Unit Size	322 mm (W) x 587.5 mm (H) x 185 mm (D) [12.68" (W) x 23.13" (H) x 7.28" (D)]

\* All information of the above is for the reference only. No prior notice is made if any changes.

Specs	
	Carbon dioxide emission 3.5 g only
	air speed 75-90 m/s
	standby power 0.3-0.4W
	1.6kW
	IP21/IP24 (optional)

Design	
	HEPA Filter+ Carbon Filter+ Antibacterial Filter
	absorbent, ceramic pad
	large drying area
	heater on/off
	sound & power adjustment
	recycled and reused

In Use	
	10-15 seconds drying time
	User friendly
	three safety protections
	60s timing protection
	easy to clean
	easy maintenance

### Operation

- Put your hands through the opening.
- Dry hands like you wash them.
- Remove hands and dryer will stop automatically.

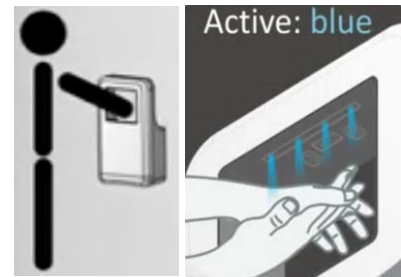
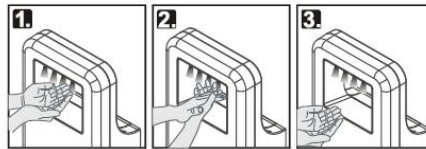

### Recommended Mounting Heights

	<b>A</b> From Top of Hand Drying Chamber	<b>B</b> From Datum Point	<b>C</b> From Bottom of Dryer
Men	1100 mm (43-9/32")	660 mm (25-61/64")	572 mm (22-31/64")
Women	1030 mm (40-33/64")	590 mm (23-13/64")	502 mm (19-47/64")
Children 4-7 years	730 mm (28-45/64")	290 mm (11-25/64")	202 mm (7-59/64")
Children 8-10 years	830 mm (32-41/64")	390 mm (15-21/64")	302 mm (11-55/64")
Children 11-13 years	915 mm (35-63/64")	475 mm (18-43/64")	387 mm (15-13/64")
Children 14-16 years	1030 mm (40-33/64")	590 mm (23-13/64")	502 mm (19-47/64")
Handicapped	850 mm (33-7/16")	410 mm (16-7/64")	322 mm (12-41/64")

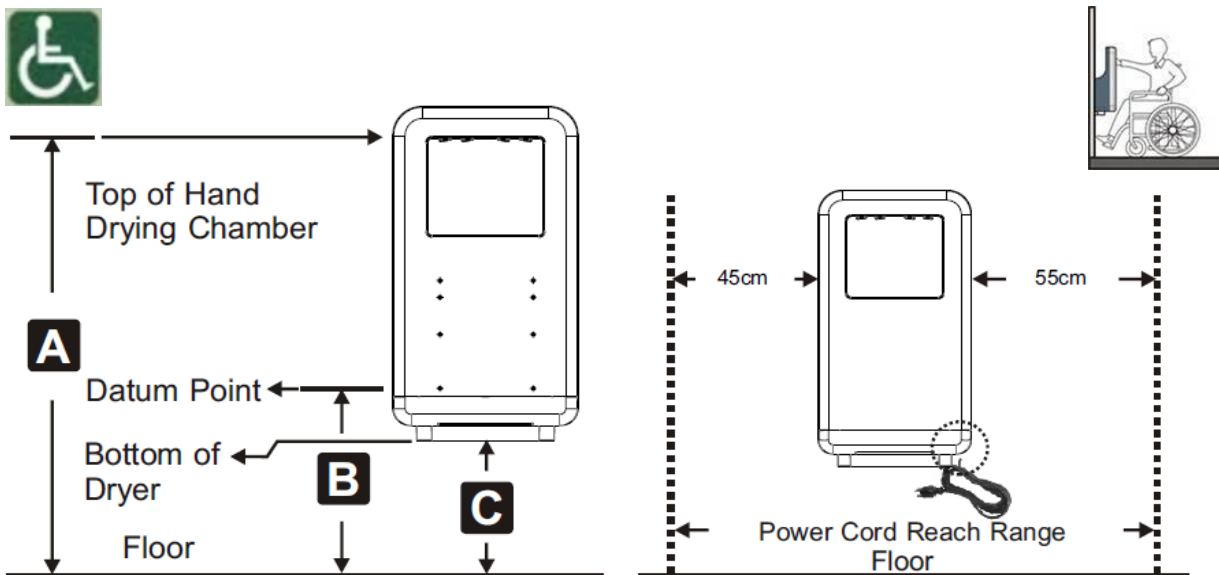

## Air Speed Adjustment

It is possible to adjust the speed of the dryer to change the sound level during operation. However, when lowering the motor speed, the drying time will increase.

The usefulness of this function will be dependent on the needs of the owner. The factory setting for dryer's motor speed will be set at its highest speed.

See below for how to adjust the dryer speed:

1. Use Allen key (supplied) to unlock and withdraw the filter access drawer.(fig. 1).
2. Use a small flat blade screwdriver to gently turn adjustment potentiometer(fig. 2) shaft clock-wise [CW] to increase power to maximum (shaft will hard stop; DO NOT OVERTURN!).
3. Turn tool gently CCW to reduce power as required (shaft will hard stop; DO NOT OVERTURN!).  
Note that at minimum power the unit may not start if there is low line Voltage.
4. Insert the filter access drawer back into the dryer and lock the security screw.

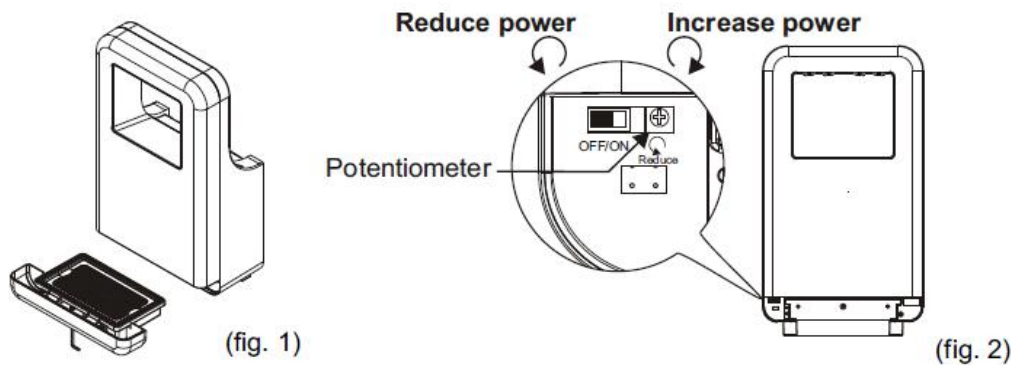

## Heater Element Switch ON/ OFF

The dryer has been designed with a heater switch that can turn the heater ON & OFF. The heater switch doesn't affect the drying time. In cold climate location, it may be more comfortable if the heat is on when drying hands. However, it will save a third of the energy used if the switch is off. This function can be adjusted depending on the needs of the owner.

The factory setting for the heater will be on.  
See below for how to turn the heater ON/OFF.

1. Use Allen key (supplied) to unlock and withdraw filter access drawer.(fig. 1).
2. Turn the Switch to the right to turn the heater ON. Switch it to the left to turn the heater OFF. (fig. 2)
3. Insert the filter access drawer back into dryer and lock the security screw.

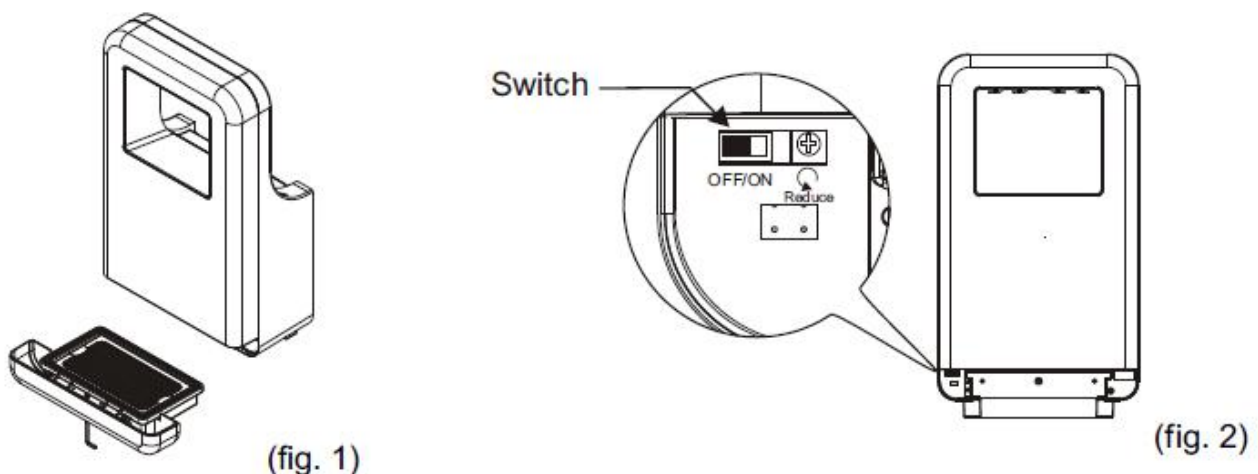

## Socket Location

The dryer is supplied with a power cord. The power cord entry position is in the rear, right side bottom of dryer. The length of the power cord is 1M. The power cord can reach to the right side within the distance of 55cm and reach to the left side within the distance of 45cm. Alternatively the unit may be hard wired to a terminal block through a rear panel Knock Out.

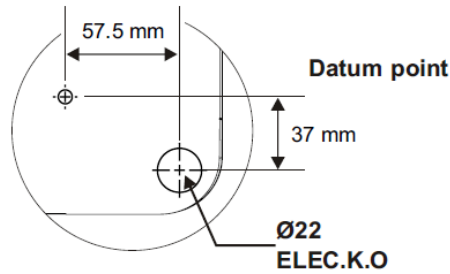

## Circuit Diagram

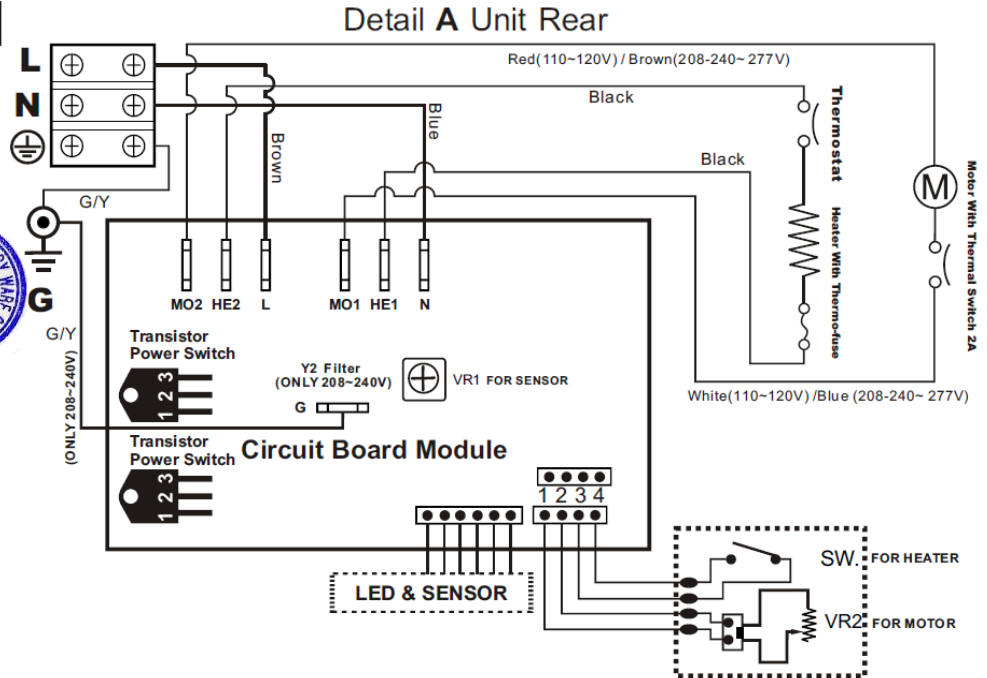

## Instructions for use, maintenance and changing the absorbent ceramic pad

The absorbent ceramic pad can absorb 70g of water, and has the capacity to take a full load approximately 280 times per day. The ceramic pad also can evaporate water. During normal use, water will be evaporated continuously and maintains its function of absorbing water. The ceramic's ability to absorb water decreases after long periods of use because it gets covered by dirt and dust. In this case, please use an abrasive sponge to wipe the surface, and the performance and function will then return to normal. Improper use or maintenance could result in breakage; see below for replacement instructions.

1. Remove drain tray if fitted then use the Allen key Supplied to loosen the security screw and remove the filter access drawer. (fig. 1)
2. Use the Allen key to loosen the security screw from the base plate and remove the dryer from the wall. (fig. 2)
3. Use a screwdriver to remove the two screws holding the ceramic pad and replace it with a new one. (fig. 3)
4. Re-Install the dryer on the base plate and secure the security screw back into the base plate.
5. Re-install the filter access drawer back and tighten the security screw.
6. It is recommended to replace the ceramic pad every year.



(fig. 1)

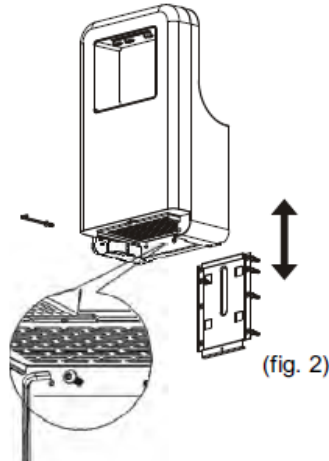

(fig. 2)

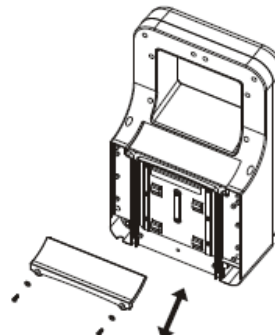

(fig. 3)





Always trying to help the environment, Hokwang has now passed the Carbon Foot Print Certification issued by BSI. Please see the results and data below:

- EcoMo is the only hand dryer that has passed the ISO14067:2013 standard, which is based on International Standards on the life cycle assessment (ISO 14040 and ISO 14044) for quantification and on environmental labels and declarations (ISO 14020, ISO 14024 and ISO 14025) for communication.
- On average, EcoMo only releases 3.5g of carbon dioxide emission/use. In countries such as Iceland (using geothermal energy) and France (using nuclear energy), the numbers are even lower.
- Compared to paper towels, which produce 16g of carbon dioxide emission/piece, EcoMo releases 79% less carbon dioxide.

	Paper Towel	Traditional Hand Dryer	EcoMo
Carbon dioxide emission	16 g	10 g	3.5g

- Paper towels typically generate more pollution and waste water during the manufacturing process. Furthermore, the cost and waste of using paper towels are much greater than high speed hand dryers.



# Instructions for use of the drain tank

Generally, the water remaining following usage will evaporate in the absorbent ceramic pad. During high usage periods, leftover water will flow into the drain tray automatically. The capacity of the drain tray is 240 ml. It's recommended to clean the drain tray every 3 months; water will come through the "overflow hole" if the drain tray is full. A drainpipe (not included) can be added if necessary. The specifications of the drainpipe is I.D. 6mm, O.D. 10mm (fig. 1)

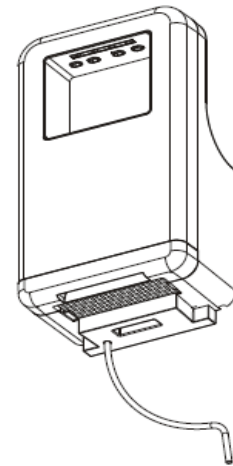

(fig. 1)

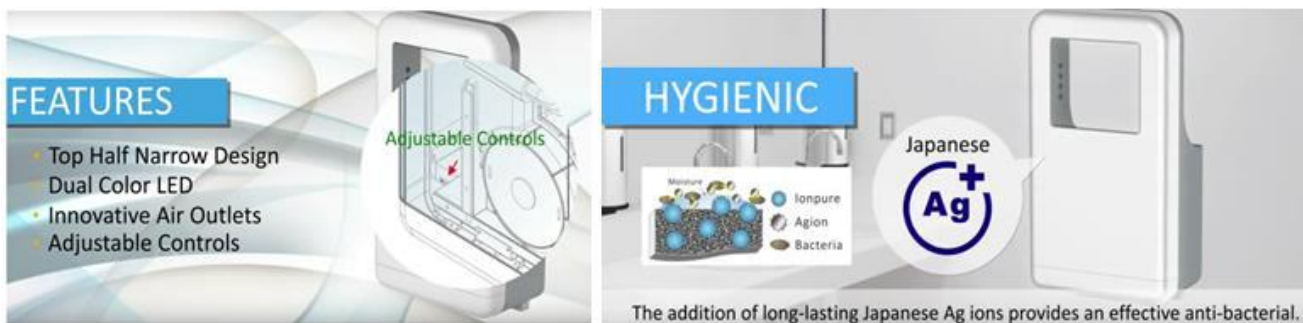

## Repair Parts List

### Key Description

- |    |                                       |
|----|---------------------------------------|
| 1  | Drawer assembly                       |
| 2  | SUPER Filter                          |
| 3  | Filter rubber                         |
| 4  | Switch cover                          |
| 5  | Cover                                 |
| 6  | Motor housing (Upper)                 |
| 7  | Motor housing rubber                  |
| 8  | Motor rubber (Small)                  |
| 9  | Motor                                 |
| 10 | Motor brush                           |
| 11 | Motor rubber (Large)                  |
| 12 | Heater assembly                       |
| 13 | Motor housing (Lower)                 |
| 14 | Air outer (right)                     |
| 15 | Air outer (left)                      |
| 16 | Chamber                               |
| 17 | Sensor & LED PCB module               |
| 18 | Bracket (right)                       |
| 19 | Bracket (left)                        |
| 20 | Security hex screw                    |
| 21 | Main PCB module                       |
| 22 | Air inlet gate                        |
| 23 | Main PCB module bracket               |
| 24 | Main bracket                          |
| 25 | Water reservoir                       |
| 26 | Switch cover                          |
| 27 | Terminal block                        |
| 28 | VR & Switch PCB                       |
| 29 | Cable gland                           |
| 30 | Back cover                            |
| 31 | Wall bracket                          |
| 32 | Backplate                             |
| 33 | Ceramic absorber                      |
| 34 | L-Wrench                              |
| 35 | C-Wrench                              |
| 36 | Crimp-on wire tips for terminal block |

### Installation Kit Included (find in carton)

1. Self-Threading pan head screws-  
№10 x 1-1/4" (M5 x 32) x 8 pcs
2. Plastic expansion anchor-  
Ø9/32" x 1-3/8" (Ø7 x 35) x 8 pcs

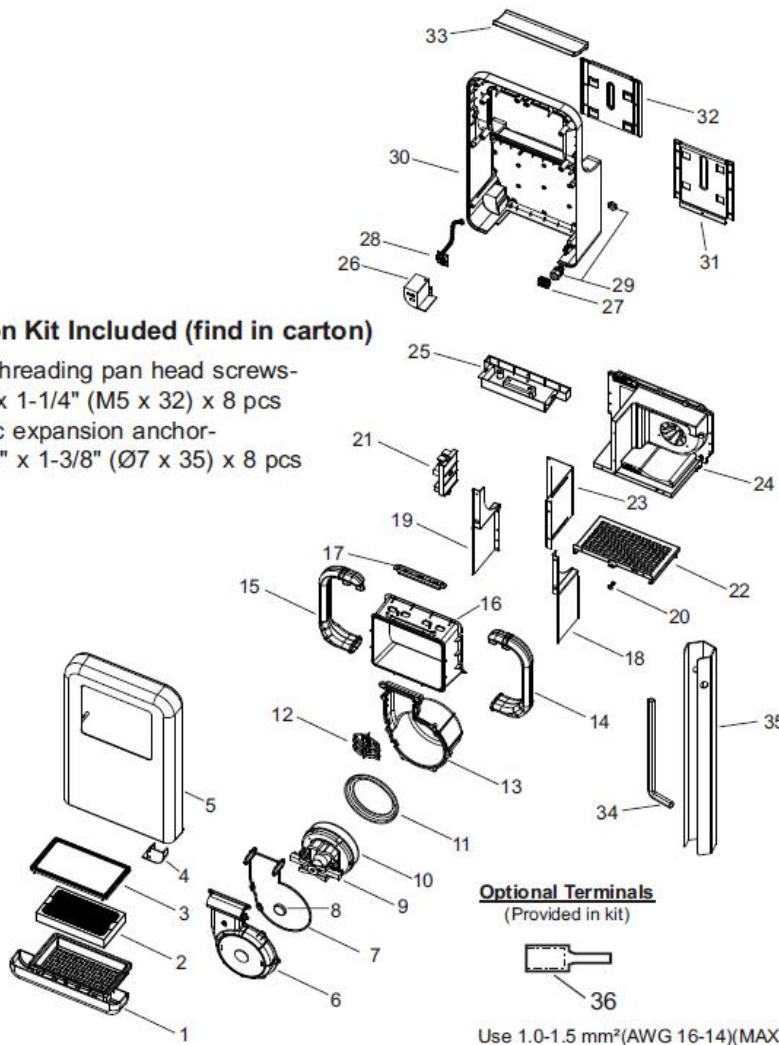

### Optional Terminals (Provided in kit)

Use 1.0-1.5 mm<sup>2</sup>(AWG 16-14)(MAX)